



FC325

**FLAT 3 25 LA COLOMBIERIE VILLAS, LA
COLOMBIERIE, ST HELIER, JE24QB**

Asking Price

£225,000

FINE & COUNTRY
JERSEY

Property details

FLYING FREEHOLD - This beautifully presented top-floor, one-bedroom apartment is part of a fully refurbished block of just three residences. Finished to a high standard with quality fixtures and fittings throughout, it's ready for immediate move-in. The apartment features an open-plan living space with a sleek, modern kitchen, double bedroom, and a stylish bathroom. Conveniently located within easy walking distance of the town centre, it's the perfect choice for a first-time buyer.

Outside

Services

Electric heating.

All Mains.

Directions

The Apartments are on Colomberie opposite the Carrefour gym.



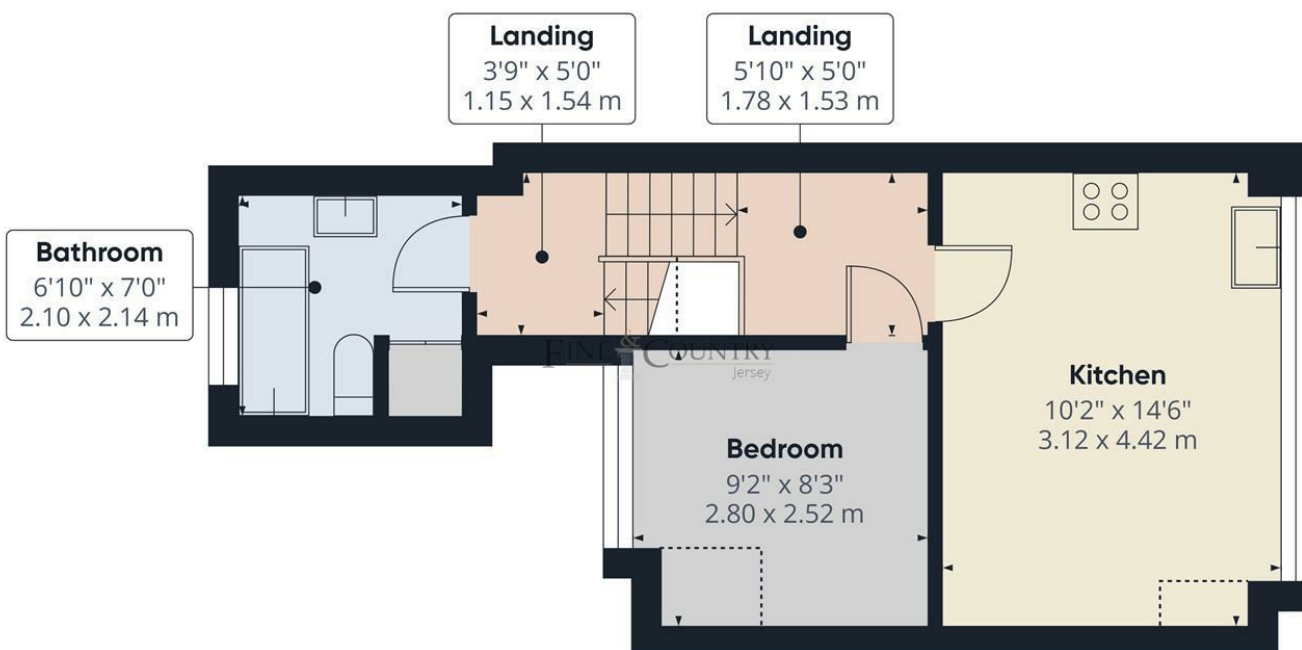

Approximate total area⁽¹⁾

331 ft²
30.7 m²

Reduced headroom

34 ft²
3.2 m²

(1) Excluding balconies and terraces

Reduced headroom

Below 5 ft/1.5 m

While every attempt has been made to ensure accuracy, all measurements are approximate, not to scale. This floor plan is for illustrative purposes only.

Calculations were based on RICS IPMS 3C standard. Please note that calculations were adjusted by a third party and therefore may not comply with RICS IPMS 3C.

GIRAFFE360

Call us on

01534 888855

jersey@fineandcountry.com

www.fineandcountry.je

5 King Street, St Helier, Jersey, JE2 4WF

MONEY LAUNDERING REGULATION - Once an offer is accepted and negotiations for the purchase of a property are entered into, the prospective purchasers will be asked to produce photographic identification and proof of residency documentation, e.g. current utility bill and ID. This is in order for us to comply with the current Money Laundering Legislation.

Fine & Country Jersey advises prospective purchasers that we have prepared these sales particulars as a general guide only. We have not carried out a detailed survey, nor tested the services, appliances and specified fittings. Room sizes are approximate and rounded; they are taken between internal wall surfaces and therefore include cupboards/shelves etc, accordingly they should not be relied upon when purchasing fittings. Carpet, curtains/blinds and kitchen equipment, whether fitted or not, are deemed to be removable by the vendor unless specifically itemised within these particulars and/or within the property inventory. These particulars are supplied on the understanding that all negotiations are conducted through Fine & Country Jersey, their accuracy is not guaranteed nor do they form part of any contract.